

DANTE FILTER



Pre-installation preparation:

- Remove the tap and filter from its packaging, check for any transport damage and that all parts are present.
- Shut off the mains water supply; switch off the water heating system, and open hot and cold taps at the lowest point in the building. Allow them to run until empty.
- Remove the old tap and prepare a 35mm diameter hole for the tap, note the tap must not pass through a surface thicker than 40mm.
- Prepare the existing pipework so the hot and cold 15mm copper feed pipes finish below the tap base. Typically the hot water feed should be on the left hand side, we recommend fitting isolation valves before the tap connections to ease any future maintenance. Any debris or swarf that may be in the feed pipes must be flushed to prevent damage to the tap.

Stage 1 Install the tap:

1. Screw the hollow fixing stud (F) into the base on the tap using a spanner or 6mm allen key. Note: the drawing identifies water inlets.
2. Screw the hot and cold tail pipes (J & K) into the base of the tap.
3. Place the base plinth then the upper seal (B) on to the base of the tap (A).
4. Place the tap centrally and straight to the tap hole, passing the hollow fixing stud (F) and tail pipes (J & K) through the sink.
5. Pass the rubber horseshoe (D) then the metal horseshoe (E) over the hollow fixing stud (F). Note: if the tap is to be fitted to a stainless steel sink then the white triangular plate (C) can be fitted where shown to improve the stability of the tap.
6. Using a spanner tighten fixing nut (G) onto the hollow fixing stud (F), a box spanner or small basin wrench will help if one is available.
7. Place fibre washer (H) into adaptor (I), tighten the adaptor (I) with its flats nearest to the tap onto the hollow fixing stud (F).
8. Attach the hot water tail pipe (J) to the water supply pipe using a 15mm compression or end feed joint. Note: the tail pipes can be carefully bent to give more space to allow these fittings to be attached.
9. Attach the 3-way valve (11) to the cold water inlet pipe (K) using compression nut (9) and olive (10).
10. Attach the 3-way valve (11) to the cold water feed pipe using compression nut (9) and olive (10).

Stage 2 Install the filter:

1. Locate a convenient position to install the filter (6&7). Leave some room underneath the filter unit (7) to allow it to be changed.
2. Screw the filter bracket (5) to the cupboard wall using screws (3).
3. Screw bracket (5) to the filter head (6) using screws (4). Note: the filter head has numbers stamped into its top, number 3 is the unfiltered water inlet and number 1 is the filtered water outlet.
4. Write the date of installation onto the label on the filter cartridge (7)
5. Insert the filter cartridge (7) into the filter head (6). Align the tabs at the top of the filter cartridge (7) with the gaps in the base of filter head (6), push the filter cartridge (7) up into the filter head (6) then turn the filter cartridge (7) approximately 90° to lock it into place.
6. Screw the pushfit fitting (1) into the adaptor nut (I).
7. Cut the blue flexible pipe (2) so it is slightly longer than the required lengths to and from the filter unit. When cutting the pipe use a sharp Stanley or craft knife, ensuring that the pipe is cut cleanly and square at all ends.
8. Firmly push the blue pipe (2) apx. 12mm into the pushfit adaptor (8) then into the inlet (stamped 3) on the filter head (6).
9. Firmly push the blue pipe (2) apx. 12mm into the pushfit fitting (1) then into the outlet (stamped 1) on the filter head (6).

Stage 3 Setting the tap up:

Slowly turn the hot and cold water supply on; now carefully check the system for any leaks.

Turn your filter tap on so filtered water runs through it. Note: when the filter is new it will take a moment to push any air through the system, you may notice some discoloration in the water at this point, this is normal and will pass with flushing.

The filtered drinking water system performs at a maximum of 2-3 L / min. Turn the mixertap fully on to filtered water, now turn the lever on the three way valve (11) to adjust the flow of filtered water to the correct level.

Clean the tap to remove any marks created during installation as instructed then replace the bag that has been provided to protect the tap until it is ready for use.

Using the tap:

For best results when using the filtered water always run the tap for a few moments. Running the tap will help to flush the system through and make the water cooler for drinking. When comparing the taste of filtered and unfiltered water always taste the filtered water first. The triple stage filter is designed to improve the taste, clarity and odour of drinking water, the filter also reduces sediment, the level of chemical impurities and lime scale build up on kettles and cookware. Each filter cartridge has a maximum six month life depending upon your water quality.

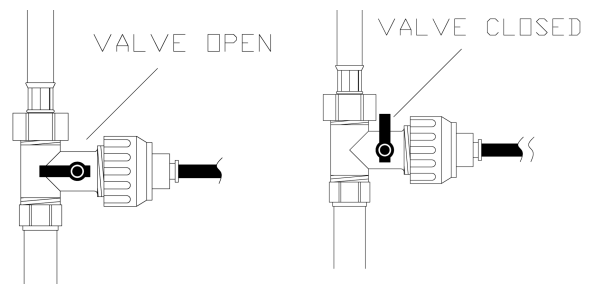

Key:	Description:	Qty.	Spare parts code
	Antisplash		1424R+color
	Spout		3465R+color
	Valve		1427R+H (Hot)
	Cartridge		3466R
	Handle		3467R+color
A	Tap body	1	
B	Base plinth & upper seal	1	3468R
C	White triangular plate (for steel sinks only)	1	
D	Rubber horseshoe	1	1985R
E	Metal horseshoe	1	
F	Hollow fixing stud	1	
G	Fixing nut	1	
H	Fibre seal	1	
I	Adaptor nut	1	
J	Hot water tail pipe	1	
K	Cold water tail pipe	1	1234R
1	Pushfit connector	1	
2	Blue flexible pipe	1	
3	Bracket mounting screws	2	
4	Filter head screws	4	
5	Filter head bracket	1	
6	Filter head	1	
7	Filter cartridge	1	
8	3-way pushfit adaptor	1	
9	Compression nut	2	
10	Compression olive	2	
11	3-way valve	1	

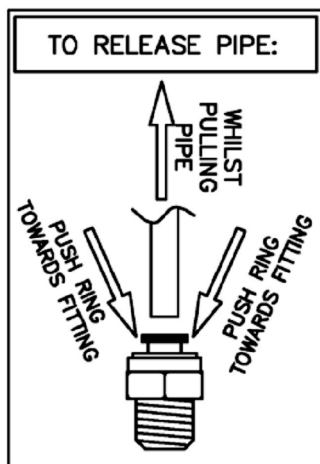
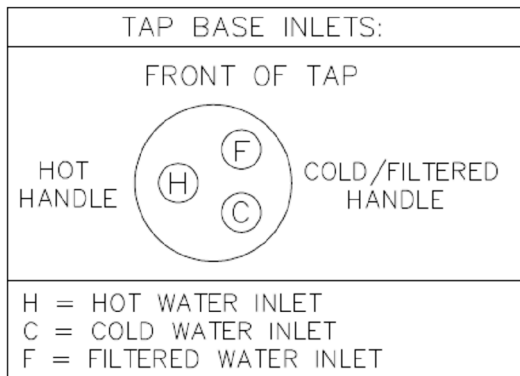
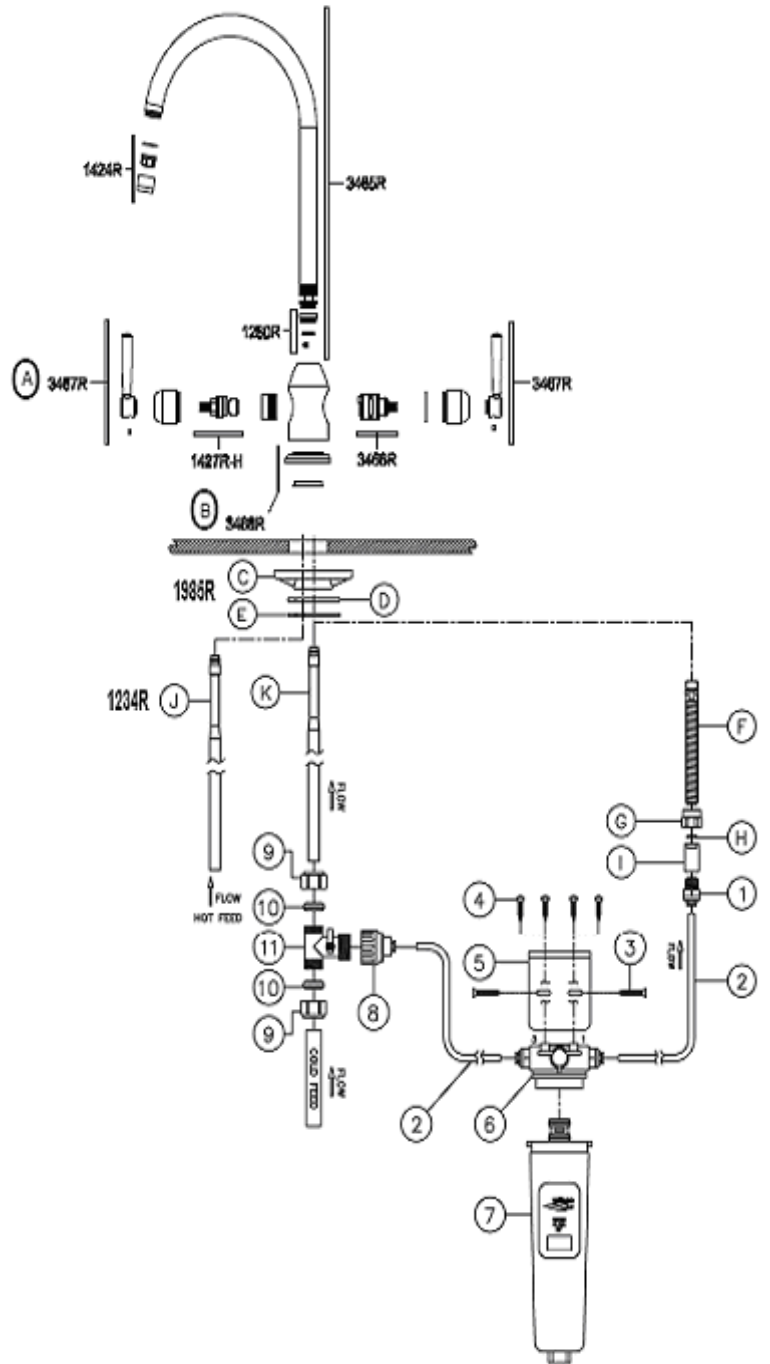

fig. 1

