

AFTER CARE:

To maintain the appearance of this tap, ensure that it is regularly cleaned only using a clean, soft damp cloth. A solution of warm water and a mild liquid detergent may be used where necessary, and then the fitting rinsed thoroughly and wiped dry. Abrasive cleaners, scouring cleaners and acid cleaners **must not be used** under any circumstances. All bath cleaning powders and liquids will damage the surface of your fitting even the non-scratch cleaners. Avoid contact with all solvents and any harsh household chemicals. You will damage the plated finish and void your guarantee.



RENO

GUARANTEE AND LIABILITY

In the unlikely event that you should experience any defect in the material or workmanship of your mixer tap within 5 years of purchase, we will replace the faulty part free of charge.

Decorative surface finishes and valves are guaranteed for one year from the date of purchase provided that our advice concerning care has been observed and no scouring agents have been used. This is provided that the mixer or tap has been used for normal domestic purposes in the UK and that the care, installation and maintenance instructions have been observed.

Scuff and scratches caused by normal wear and tear, improper installation or accidental damage are excluded from this guarantee.

You should retain a copy of your dated invoice as proof of purchase to validate any claims under this guarantee.

No other warranties, express or implied, are made, including merchantability or fitness for a particular purpose.

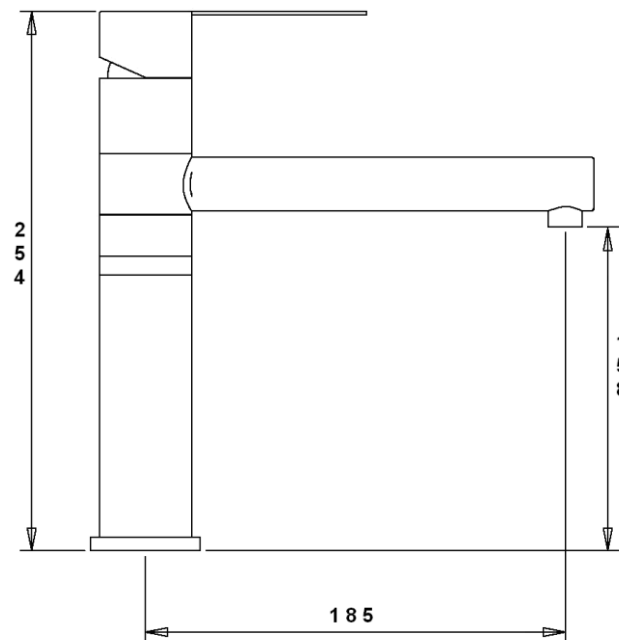

SPARE PARTS AND SERVICE

Contact
Phone
Fax
e-mail
web-site

CARRON PHOENIX
01324 638321
01324 611962
sales@carron.com
www.carron.com

Fitting Instructions & Contents List

Please keep these instructions for future reference and request of replacement parts.

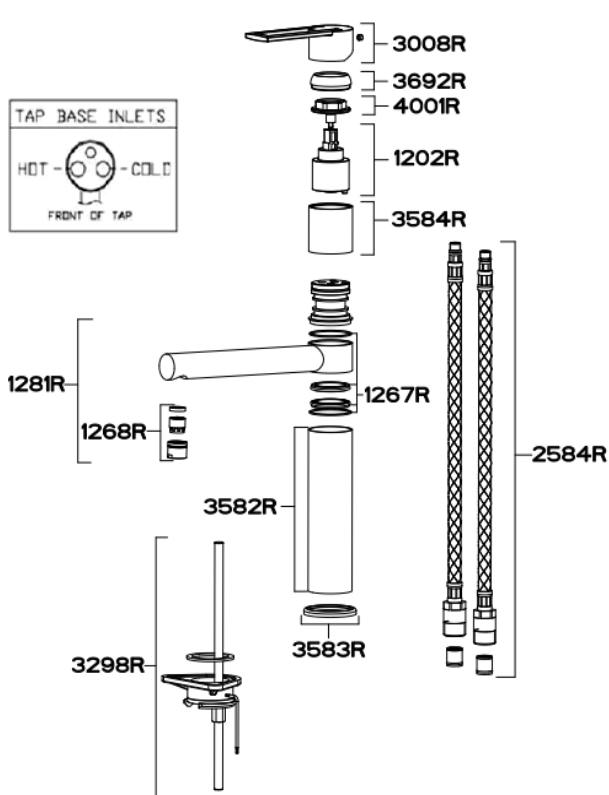

CODE	DESCRIPTION
3008R+color	Handle
3692R+color	Collar
4001R	Bush
1202R	Cartridge
3584R+color	Mixer ring
1281R+color	Spout
1268R+color	Antisplash
1267R	O.ring kit
3582R+color	Base column
3583R+color	Plinth
3298R	Fixing kit
2584R	Flexi tails

In the unlikely event you find a part missing please contact our Customer Service Help line on 01324-638321 for immediate dispatch of part.

Maintenance:

Where an aerator is fitted to the outlet of the spout, it will need occasional cleaning. This will be evident when the water flow slows down to an unacceptable level. To accomplish this unscrew the outlet in an anti-clockwise direction and remove the mesh. Immerse the mesh in a suitable descaling fluid overnight, rinse thoroughly in clean water and re-install.

Remember:

Maximum water supply pressure: 75 PSI (5 bar)
 Maximum hot-water supply temperature: 70 °C
 Recommended hot-water supply temperature: 65 °C

If these temperatures or water pressure are exceeded damage to the tap can result. A pressure reducing valve may be required to be fitted in high water pressure situations.

Please read these instructions before you install and use the tap. All designs, descriptions and dimensions are subject to change without notice.

Preparation

Flush the plumbing system before installing the mixer tap. This is to avoid plumbing residues clogging the mesh of the aerated outlet, or possibly damaging the valve's washers. This is especially important where extensive plumbing work has been carried out.

First shut off your water heating system then, with your mains stop cock closed, open the lowest hot and cold taps in the house and allow to run until the cold storage tank and pipes are empty. (The hot water storage cylinder always remains full).

Installation

1. Align the spout with the centre position of the handle lever on the valve
2. Screw in the fixing stud into the base of the tap
3. Pass the base column over the fixing stud to the base of the tap body
4. Place the upper seal onto the base plinth, then place both these parts onto the base column
5. Screw the hot and cold flexible tail pipes into the base of the tap body where shown
6. Place the mixertap onto the sink or worktop and pass the tail pipes and studded rod through the taphole. With the tap in place check that the flexi tail pipes meet the hot and cold water feeds. If further adjustment to the plumbing is required do this now
7. If fitting the tap to a stainless steel sink, the white triangular stabiliser can be placed where shown to help to stabilise the weight of the tap.
8. Pass the rubber horseshoe and then metal horseshoe over the fixing stud and around flexi tail pipes
9. Fasten the fixing nut securely onto the fixing stud fixing the tap into its correct location.
10. Connect the Hot & Cold water flexi tail pipes to the water supplies using ½" BSP x 15mm compression fittings or similar.